

BD121-37T Series

DC Blower

121x121x37mm

Specification:

- **Air Flow** : 22 ~ 26 CFM
- **Housing** : Spiral Housing of Fiberglass- Reinforced Polycarbonate
Housing Base of Galvanized Steel Plate
- **Impeller** : Fiberglass- Reinforced Polycarbonate
- **Bearing** : Ball or Sleeve
- **Termination** : Lead Wire UL 1007 AWG#24 or Equivalent
Red Wire Positive (+); Black Wire Negative (-);
Yellow Wire Function (3)
- **Operating Temperature** : -10°C to + 70°C for Sleeve Type
-20°C to + 80°C for Ball Type
- **Weight** : 500g
- **Function** :
P: Protection (Automatic restart when lock up removed)
A: Alarm (optional)

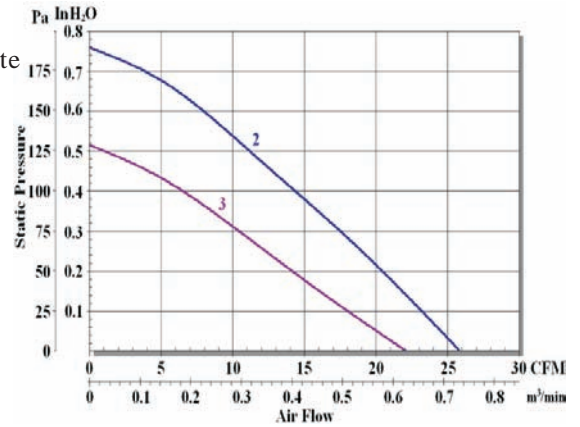

Outline Dimension

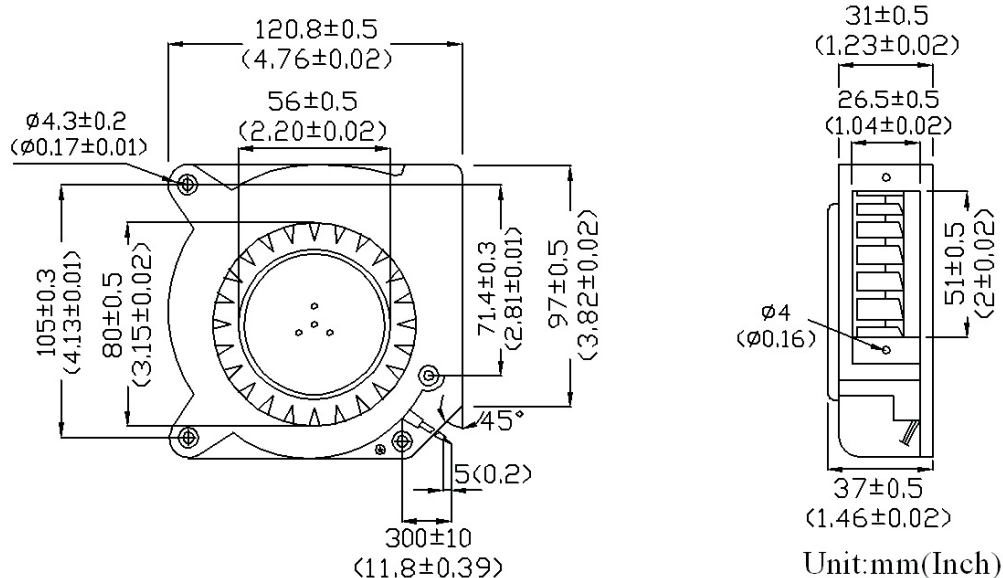

Item Code	Rated Voltage	Rated Current (A)	Input Power (W)	Speed RPM	Max. Air Flow		Noise dB(A)
					CFM	m³/min	
BD12V121-37T-FPJ-B25-N2P	12V	0.95	11.5	2800	26	0.73	55
BD12V121-37T-FPJ-B25-N3P	12V	0.63	7.5	2500	22	0.62	52
BD24V121-37T-FPJ-B25-N2P	24V	0.42	10	2800	26	0.73	55
BD24V121-37T-FPJ-B25-N3P	24V	0.31	7.5	2500	22	0.62	52
BD48V121-37T-FPJ-B25-N2P	48V	0.23	11	2800	26	0.73	55
BD48V121-37T-FPJ-B25-N3P	48V	0.16	7.7	2500	22	0.62	52